

Harry Smith 367S ALTERNATE

How to read your map

This map will help you locate proposed routes in relation to your property. The side titled DETAILED BASE highlights routing considerations such as urban areas and hydrology (surface water). The other side titled DETAILED PHOTO is an aerial image which provides landscape details.

The black dots and corresponding letters and numbers (for example E50) located on the proposed routes will help you to identify the route segment you are closest to.

See newsletter for further details.

- Green lines represent the proposed alternate route for the new 138 kV transmission line. The alternate route would be built using triple circuit structures. The line is located on the west side of Range Road 270 except for an approximately 400m segment just north of E25.
- Pink lines represent the proposed alternative route for the new 240 kV transmission lines.
- Red and yellow dashed line represents the proposed rebuild portion of the existing 739L transmission line. The rebuild portion is common to both the preferred and alternate options.
- Green square represents the proposed upgrade of the Acheson Substation.
- Blue hatched box represents a proposed substation site for the Harry Smith 367S Substation.

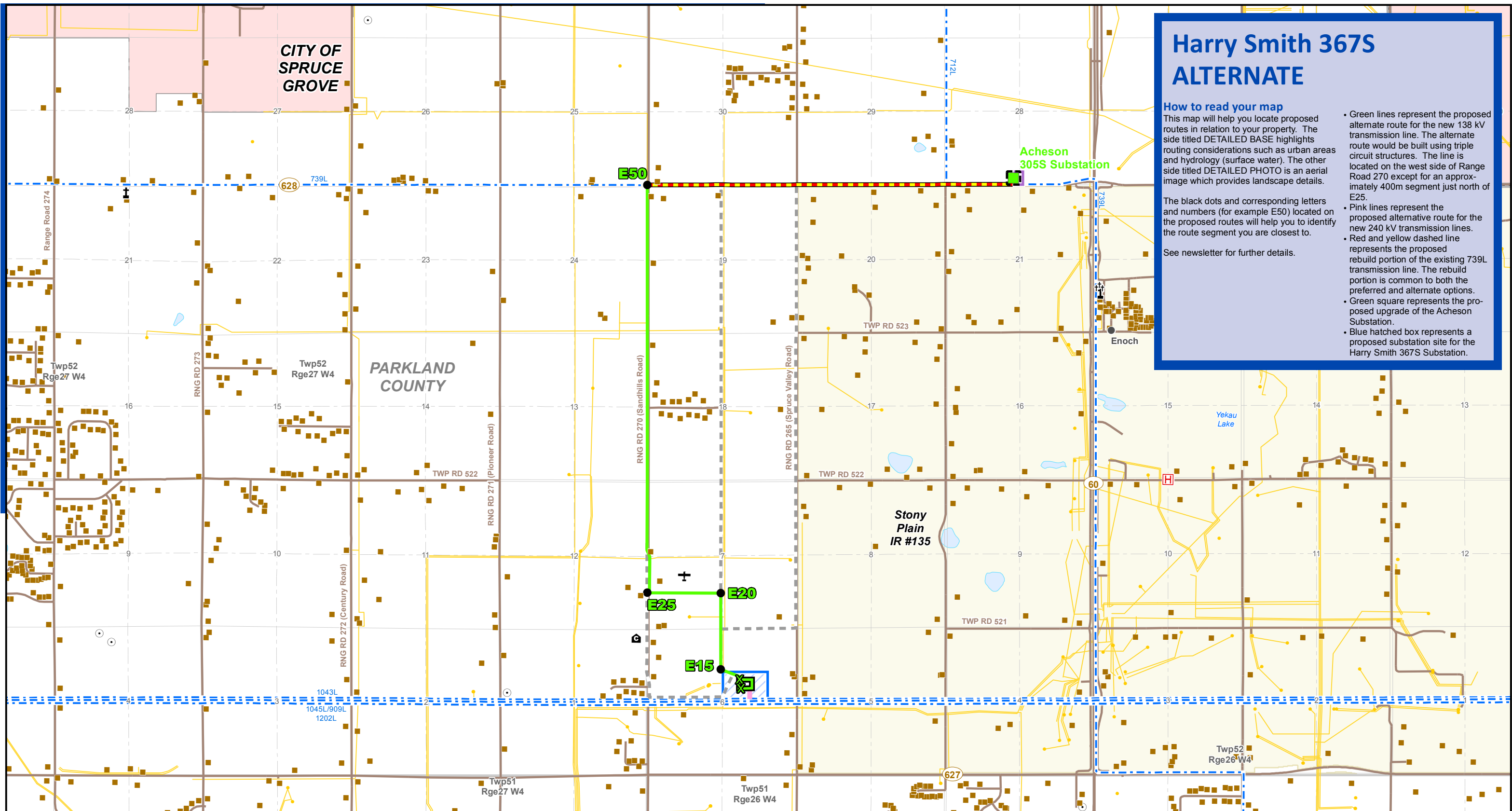

LEGEND		
● Point Designation	▭ Proposed Substation Site	■ Residence
■ Proposed Substation Upgrade	✚ Airstrip	● Wellsite
— Proposed Alternate 138kV Transmission Line	✚ Cemetery	— Pipeline
— Proposed Alternate 240kV Transmission Line	✚ Church	— Road
— Proposed Salvage/Rebuild of Existing 739L	⊙ Communication Tower	▭ First Nations Reserve
— Previously Considered Route	⊙ Community Centre	▭ Urban Area
— Existing Transmission Line	● Hamlet or Locality	▭ Water Body
▭ Proposed Substation Expansion	⊙ Hospital	
▭ Proposed Alternate Substation Fenceline		

NO: 35017014-6201
 DRAWN: MS - EBA
 FILE NO.: C22203149-02
 REVISION: 2.01.00
 AL FOLDER: Harry Smith
DATE: 2014-05-21

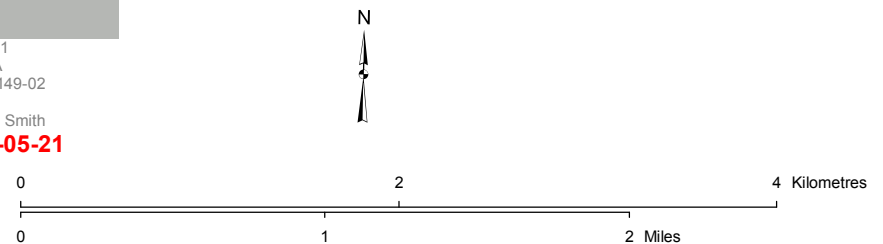

Although there is no reason to believe that there are any errors associated with the data used to generate this product or in the product itself, users of these data are advised that errors in the data may be present.

DETAIL BASE **DB1**

ALTALINK

PROPOSED
 South and West of Edmonton Area
 Transmission Development:
 Harry Smith 367S Substation and Transmission Lines
 Alternate