

CITY OF
SPRUCE
GROVE

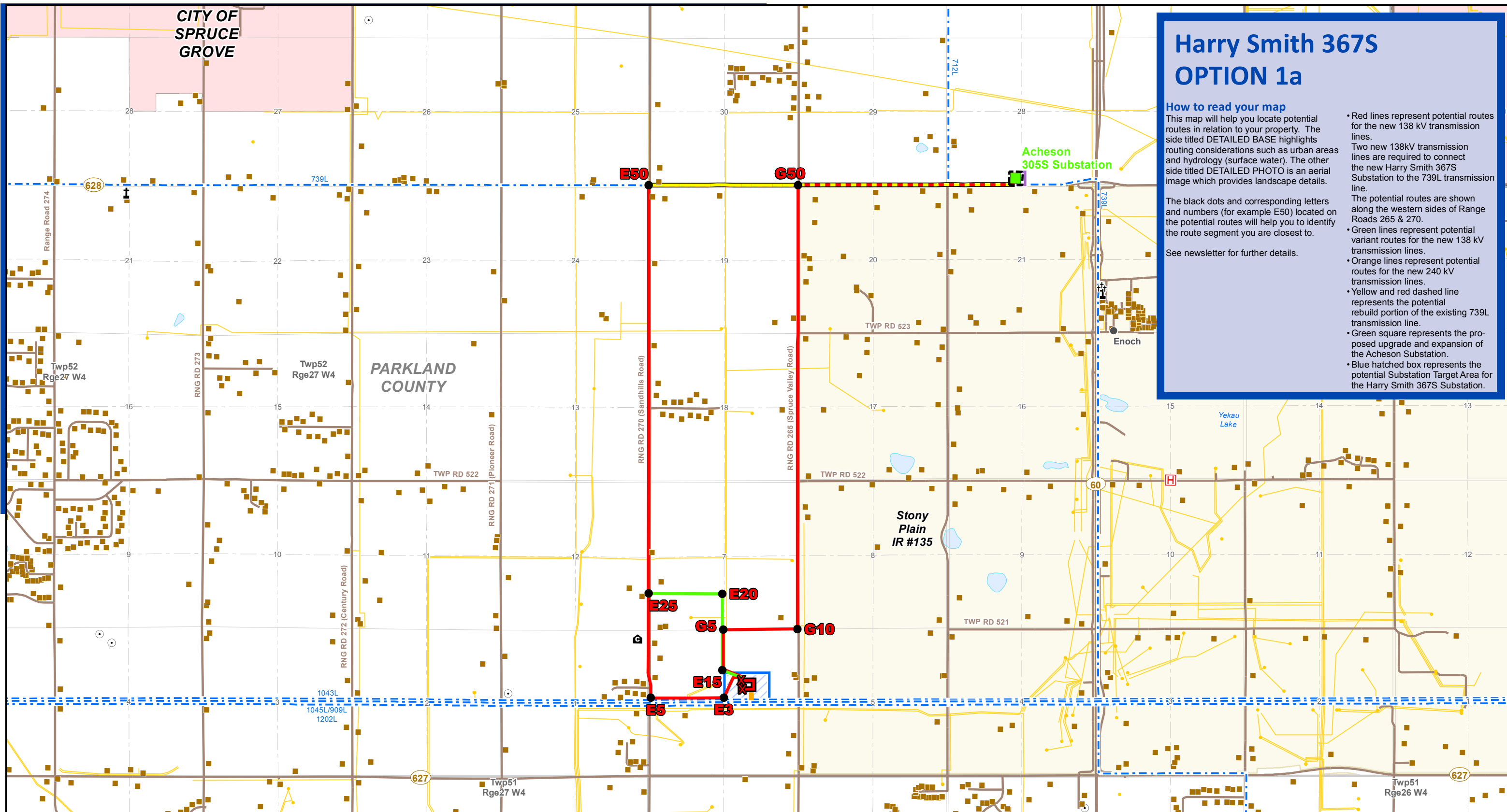

Harry Smith 367S OPTION 1a

How to read your map

This map will help you locate potential routes in relation to your property. The side titled DETAILED BASE highlights routing considerations such as urban areas and hydrology (surface water). The other side titled DETAILED PHOTO is an aerial image which provides landscape details.

The black dots and corresponding letters and numbers (for example E50) located on the potential routes will help you to identify the route segment you are closest to.

See newsletter for further details.

- Red lines represent potential routes for the new 138 kV transmission lines.
- Two new 138kV transmission lines are required to connect the new Harry Smith 367S Substation to the 739L transmission line.
- The potential routes are shown along the western sides of Range Roads 265 & 270.
- Green lines represent potential variant routes for the new 138 kV transmission lines.
- Orange lines represent potential routes for the new 240 kV transmission lines.
- Yellow and red dashed line represents the potential rebuild portion of the existing 739L transmission line.
- Green square represents the proposed upgrade and expansion of the Acheson Substation.
- Blue hatched box represents the potential Substation Target Area for the Harry Smith 367S Substation.

LEGEND

- | | | |
|--|------------------------------------|--------------------------------|
| ● Point Designation | ▭ Potential Substation Fenceline | ■ Residence |
| ■ Potential Substation Upgrade | ▭ Potential Substation Target Area | ● Wellsite |
| — Potential 138kV Transmission Line | ⛪ Cemetery | — Pipeline |
| — Potential 138kV Transmission Line Variant | ⛪ Church | — Road |
| — Potential 240kV Transmission Line | ⊙ Communication Tower | — First Nations Reserve |
| — Potential Salvage of Existing 739L | ⛪ Community Centre | — Municipal or County Boundary |
| — Potential Salvage/Rebuild of Existing 739L | ● Hamlet or Locality | — Urban Area |
| — Existing Transmission Line | ⛪ Hospital | — Water Body |
| — Potential Substation Expansion | | |

NO: 35017014-6201
DRAWN: BB - EBA
FILE NO.: C22203149-02
REVISION: 1.00.01
AL FOLDER: Harry Smith
DATE: 2014-02-12

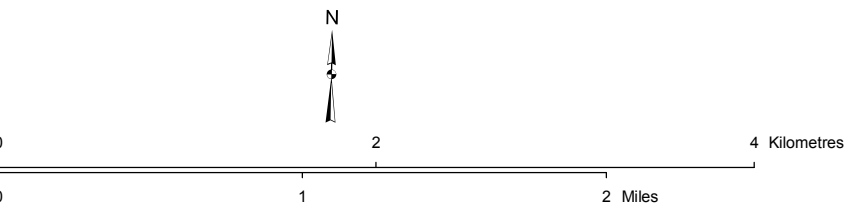

Although there is no reason to believe that there are any errors associated with the data used to generate this product or in the product itself, users of these data are advised that errors in the data may be present.

DETAIL BASE **DB1a**

ALTALINK

POTENTIAL
South and West of Edmonton Area
Transmission Development:
Harry Smith 367S Substation and Transmission Lines
Option 1a