

CITY OF  
SPRUCE  
GROVE

# Harry Smith 367S OPTION 1b

## How to read your map

This map will help you locate potential routes in relation to your property. The side titled DETAILED BASE highlights routing considerations such as urban areas and hydrology (surface water). The other side titled DETAILED PHOTO is an aerial image which provides landscape details.

The black dots and corresponding letters and numbers (for example E50) located on the potential routes will help you to identify the route segment you are closest to.

See newsletter for further details.

- Purple lines represent potential routes for a new triple circuit 138 kV transmission line. One new triple circuit 138 kV transmission line would be required to connect the new Harry Smith 367S Substation to the 739L transmission line.
- Orange lines represent potential routes for the new 240 kV transmission lines.
- Yellow and red dashed line represents the potential rebuild portion of the existing 739L transmission line.
- Green square represents the proposed upgrade and expansion of the Acheson Substation.
- Blue hatched box represents the potential Substation Target Area for the Harry Smith 367S Substation.

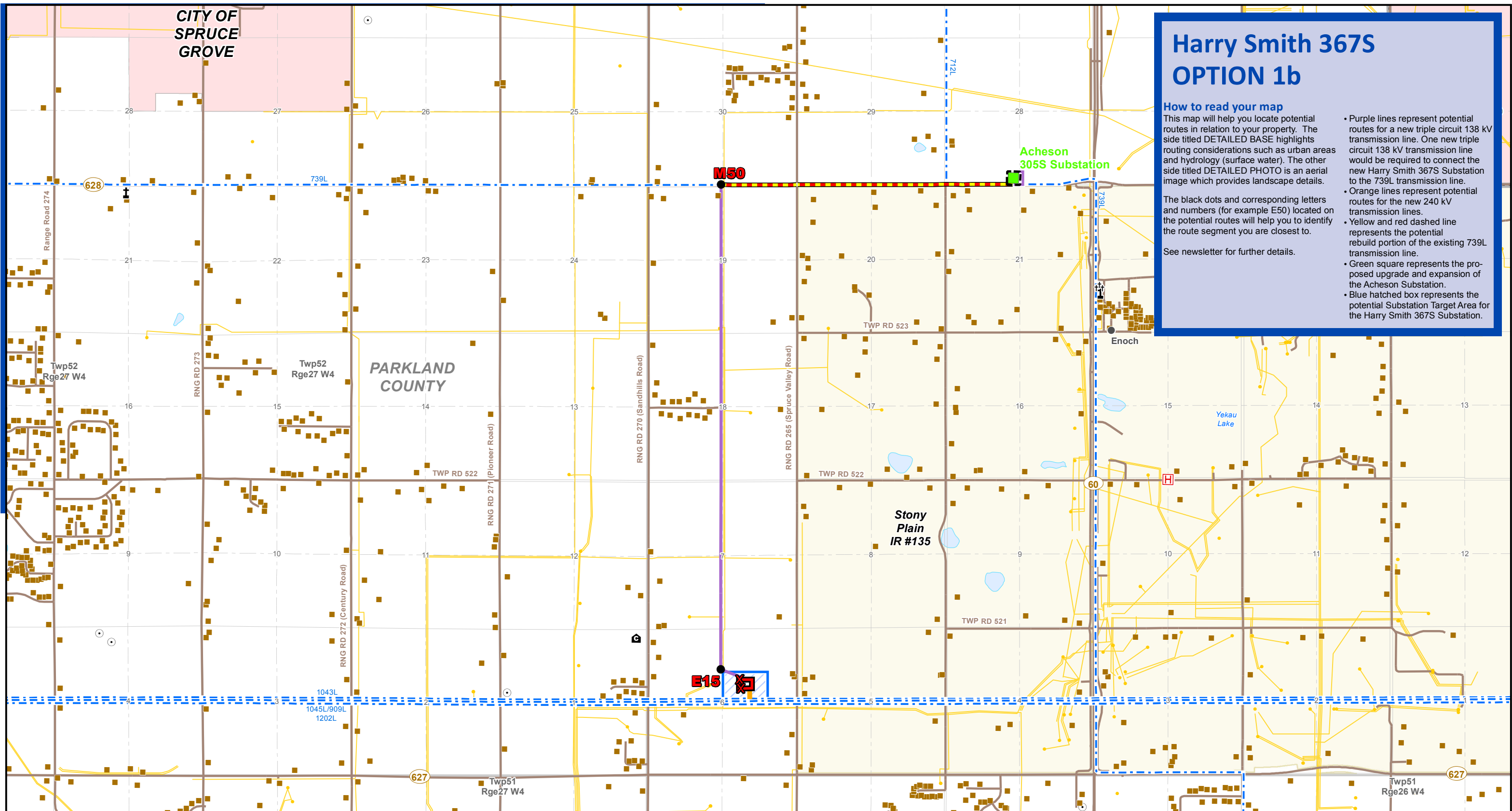

LEGEND			
	Point Designation		Pipeline
	Potential Substation Upgrade		Road
	Potential 138 kV Triple Circuit Transmission Line		First Nations Reserve
	Potential 240kV Transmission Line		Municipal or County Boundary
	Potential Salvage/Rebuild of Existing 739L		Urban Area
	Existing Transmission Line		Water Body
	Potential Substation Expansion		Cemetery
	Potential Substation Fenceline		Church
	Potential Substation Target Area		Communication Tower
			Community Centre
			Hamlet or Locality
			Hospital
			Residence
			Wellsite

NO: 35017014-6201  
 DRAWN: BB - EBA  
 FILE NO.: C22203149-02  
 REVISION: 1.00.00  
 AL FOLDER: Harry Smith  
**DATE: 2014-02-12**

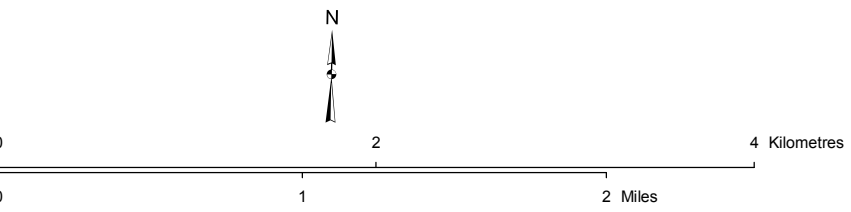

Although there is no reason to believe that there are any errors associated with the data used to generate this product or in the product itself, users of these data are advised that errors in the data may be present.

DETAIL BASE **DB1b**

**ALTALINK**

**POTENTIAL**  
 South and West of Edmonton Area  
 Transmission Development:  
 Harry Smith 367S Substation and Transmission Lines  
 Option 1b