

CITY OF  
SPRUCE  
GROVE

# Harry Smith 367S OPTION 2a

## How to read your map

This map will help you locate potential routes in relation to your property. The side titled DETAILED BASE highlights routing considerations such as urban areas and hydrology (surface water). The other side titled DETAILED PHOTO is an aerial image which provides landscape details.

The black dots and corresponding letters and numbers (for example E50) located on the potential routes will help you to identify the route segment you are closest to.

See newsletter for further details.

- Red lines represent potential routes for the new 138 kV transmission lines.
- Two new 138kV transmission lines are required to connect the new Harry Smith 367S Substation to the 739L transmission line.
- The potential routes are shown along the western sides of Range Roads 270 & 271.
- Orange lines represent potential routes for the new 240 kV transmission lines.
- Yellow and red dashed line represents the potential rebuild portion of the existing 739L transmission line.
- Green square represents the proposed upgrade and expansion of the Acheson Substation.
- Blue hatched box represents the potential Substation Target Area for the Harry Smith 367S Substation.

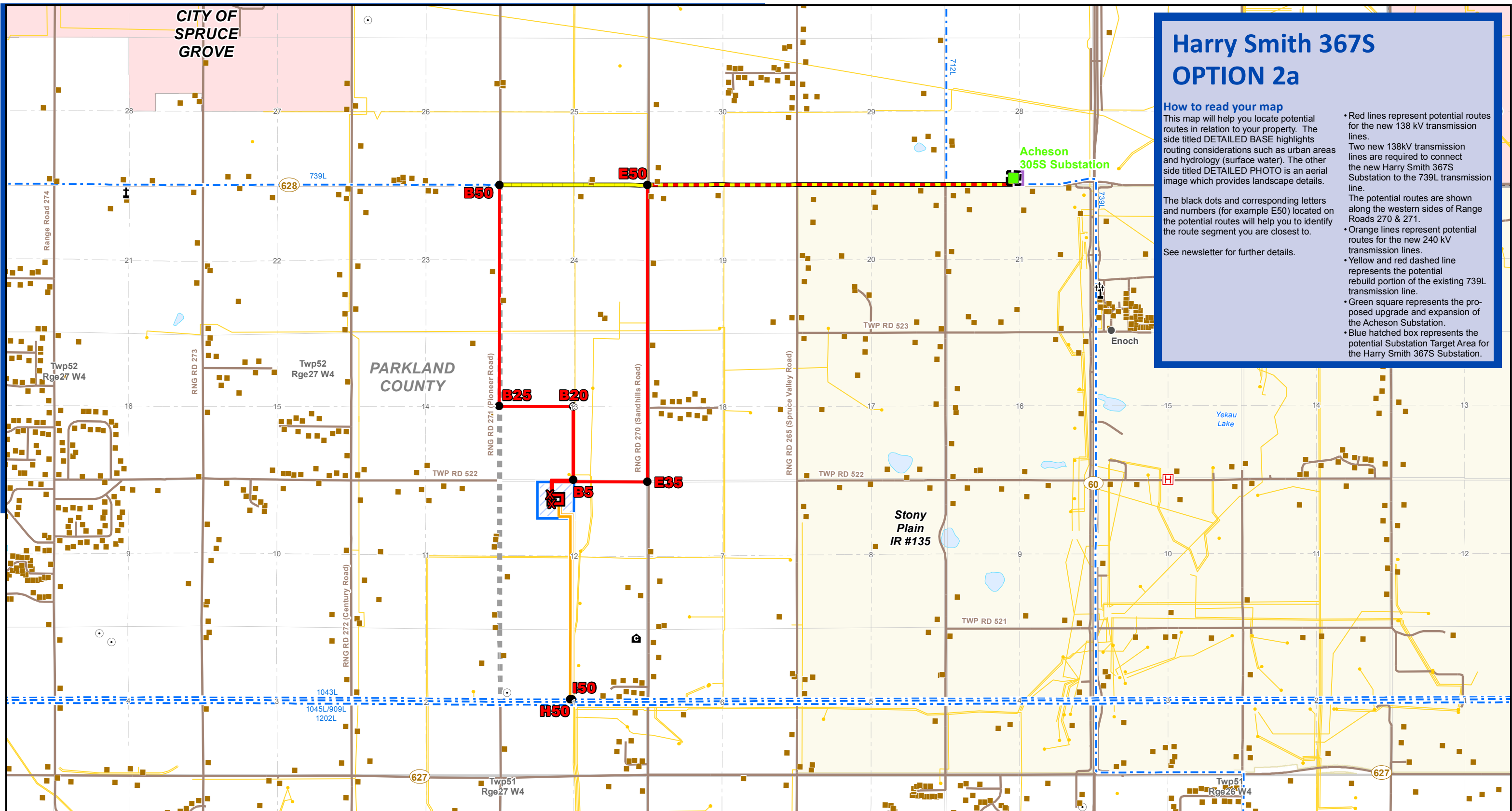

LEGEND	
	Point Designation
	Potential Substation Upgrade
	Potential 138kV Transmission Line
	Potential 240kV Transmission Line
	Potential Salvage of Existing 739L
	Potential Salvage/Rebuild of Existing 739
	Previously Considered Route
	Existing Transmission Line
	Potential Substation Expansion
	Potential Substation Fenceline
	Potential Substation Target Area
	Cemetery
	Church
	Communication Tower
	Community Centre
	Hamlet or Locality
	Hospital
	Residence
	Wellsite
	Pipeline
	Road
	First Nations Reserve
	Municipal or County Boundary
	Urban Area
	Water Body

NO: 35017014-6201  
 DRAWN: BB - EBA  
 FILE NO.: C22203149-02  
 REVISION: 1.00.01  
 AL FOLDER: Harry Smith  
**DATE: 2014-02-12**

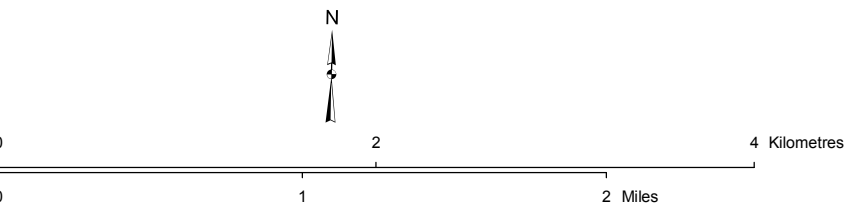

Although there is no reason to believe that there are any errors associated with the data used to generate this product or in the product itself, users of these data are advised that errors in the data may be present.

DETAIL BASE **DB2a**

**ALTALINK**

**POTENTIAL**

South and West of Edmonton Area  
Transmission Development:

Harry Smith 367S Substation and Transmission Lines  
Option 2a