

CITY OF
SPRUCE
GROVE

Harry Smith 367S OPTION 2b

How to read your map

This map will help you locate potential routes in relation to your property. The side titled DETAILED BASE highlights routing considerations such as urban areas and hydrology (surface water). The other side titled DETAILED PHOTO is an aerial image which provides landscape details.

The black dots and corresponding letters and numbers (for example E50) located on the potential routes will help you to identify the route segment you are closest to.

See newsletter for further details.

- Purple lines represent potential routes for a new triple circuit 138 kV transmission line. One new triple circuit 138 kV transmission line would be required to connect the new Harry Smith 367S Substation to the 739L transmission line.
- Orange lines represent potential routes for the new 240 kV transmission lines.
- Yellow and red dashed line represents the potential rebuild portion of the existing 739L transmission line.
- Green square represents the proposed upgrade and expansion of the Acheson Substation.
- Blue hatched box represents the potential Substation Target Area for the Harry Smith 367S Substation.

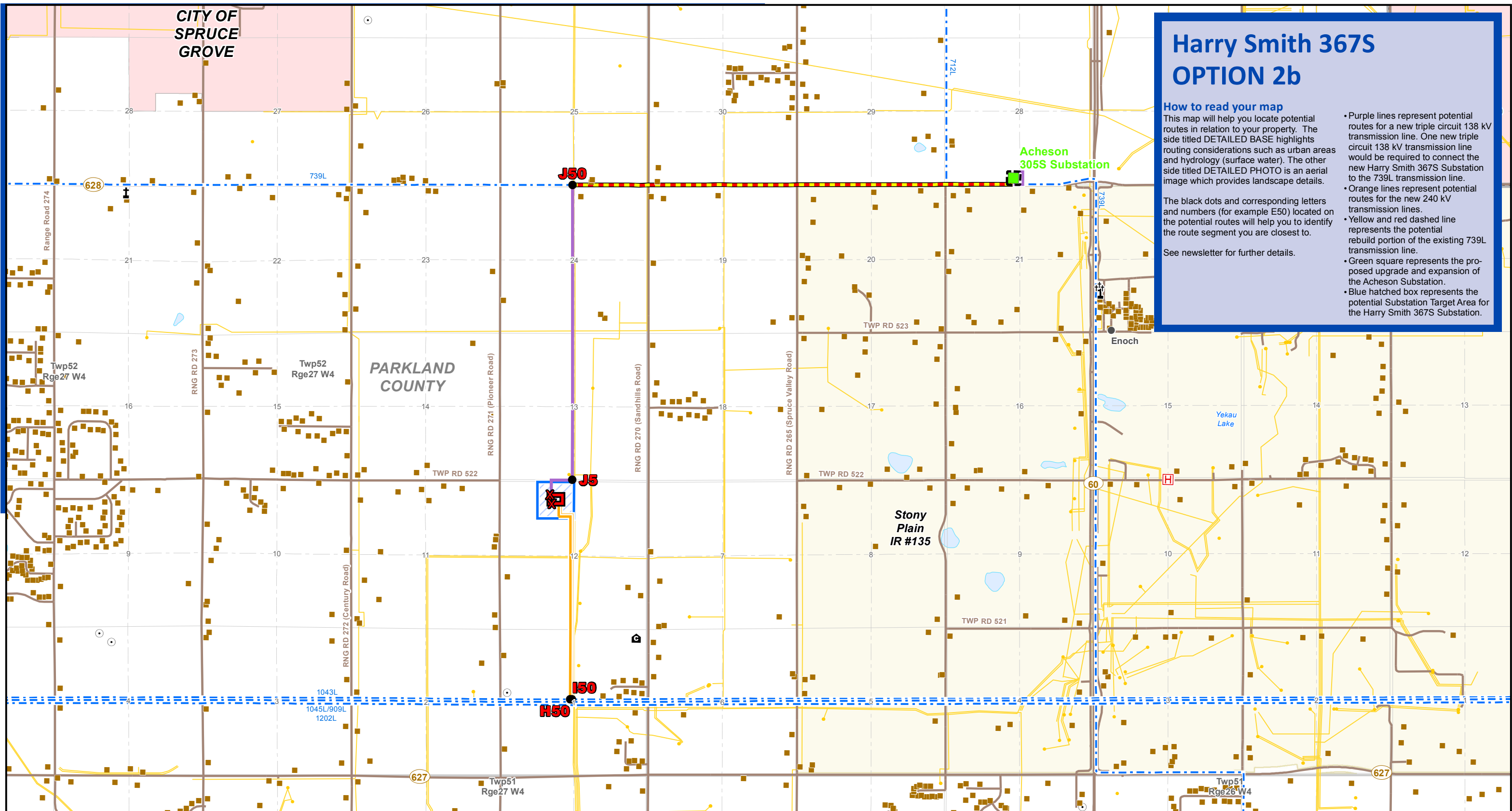

LEGEND

- | | | |
|---|------------------------------------|--------------------------------|
| ● Point Designation | ▭ Potential Substation Target Area | ● Wellsite |
| ■ Potential Substation Upgrade | ✠ Cemetery | — Pipeline |
| — Potential 138 kV Triple Circuit Transmission Line | ✠ Church | — Road |
| — Potential 240kV Transmission Line | ⊙ Communication Tower | ▭ First Nations Reserve |
| — Potential Salvage/Rebuild of Existing 739 | ⊙ Community Centre | ▭ Municipal or County Boundary |
| — Existing Transmission Line | ● Hamlet or Locality | ▭ Urban Area |
| ▭ Potential Substation Expansion | ⊠ Hospital | ▭ Water Body |
| ▭ Potential Substation Fenceline | ■ Residence | |

NO: 35017014-6201
DRAWN: BB - EBA
FILE NO.: C22203149-02
REVISION: 1.00.00
AL FOLDER: Harry Smith
DATE: 2014-02-12

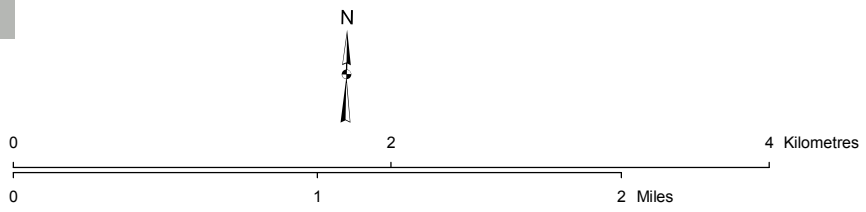

Although there is no reason to believe that there are any errors associated with the data used to generate this product or in the product itself, users of these data are advised that errors in the data may be present.

DETAIL BASE **DB2b**

ALTALINK

POTENTIAL

South and West of Edmonton Area
Transmission Development:

Harry Smith 367S Substation and Transmission Lines
Option 2b