

NOTES

454L/455L: 20 m of Right of Way will be required. Up to an additional 20 metres of workspace may be required for construction activities, including vegetation removal. Up to 100 metres of workspace may be required for stringing activities behind corner structures. See newsletter for further details.
858L/174L: 21 m of Right of Way will be required. Up to an additional 20 metres of workspace may be required for construction activities, including vegetation removal. Up to 100 metres of workspace may be required for stringing activities behind corner structures. See newsletter for further details.
1140L/1112L and 910L/914L: 38 m of Right of Way will be required. Up to an additional 10 metres of workspace may be required for construction activities, including vegetation removal. Up to 115 metres of workspace may be required for stringing activities behind corner structures. See newsletter for further details.

Saunders Lake 289S OPTION 2

How to read your map

This map will help you to locate the project area in relation to your property. The side of the map titled **DETAIL BASE** highlights routing considerations such as urban areas, residences and hydrology (surface water). The other side of the map titled **DETAIL PHOTO** is an aerial image and provides landscape details.

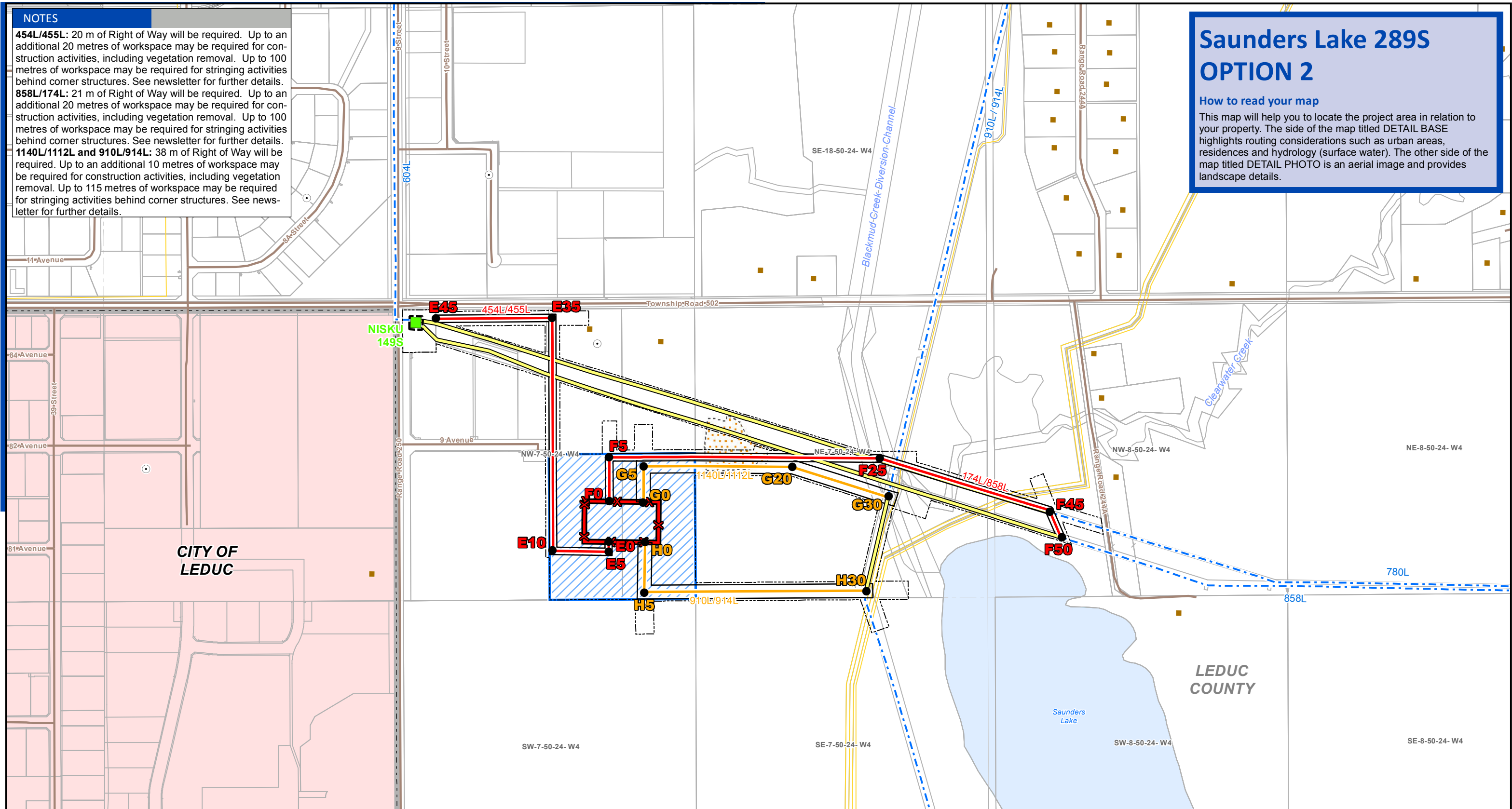

LEGEND

- Point Designation
- Potential Substation Upgrade
- Potential 138 kV Transmission Line
- Potential 240 kV Transmission Line
- Potential Salvaged Transmission Line
- - - Existing Transmission Line
- ⊗ Potential Substation Fenceline
- ▨ Potential Substation Site
- ▭ Potential Construction Workspace
- ▭ Right-of-Way Boundary
- Communication Tower
- Residence
- Pipeline
- Road
- ⊗ Gravel Pit
- ▭ Municipal or County Boundary
- Urban Area
- Water Body

NO: 35017014-6202
 DRAWN: SW - EBA
 FILE NO.: C22203149-03
 REVISION: 1.00.00
 AL FOLDER: Saunders Lake
DATE: 2013-12-18

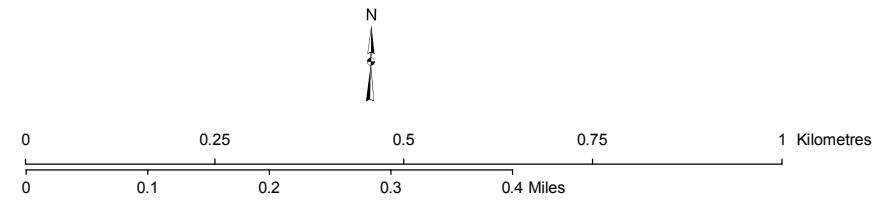

DETAIL BASE **DB2**



POTENTIAL
 South and West of Edmonton Area
 Transmission Development:

Option 2 - Saunders Lake 289S Substation and Transmission Lines

Although there is no reason to believe that there are any errors associated with the data used to generate this product or in the product itself, users of these data are advised that errors in the data may be present.