

**NOTES**

Approximately 10 x 180 m of construction workspace will be required on either side of the existing 658L right-of-way.

The proposed guy anchor box will extend 35 m from the new structure and be 15 m wide.

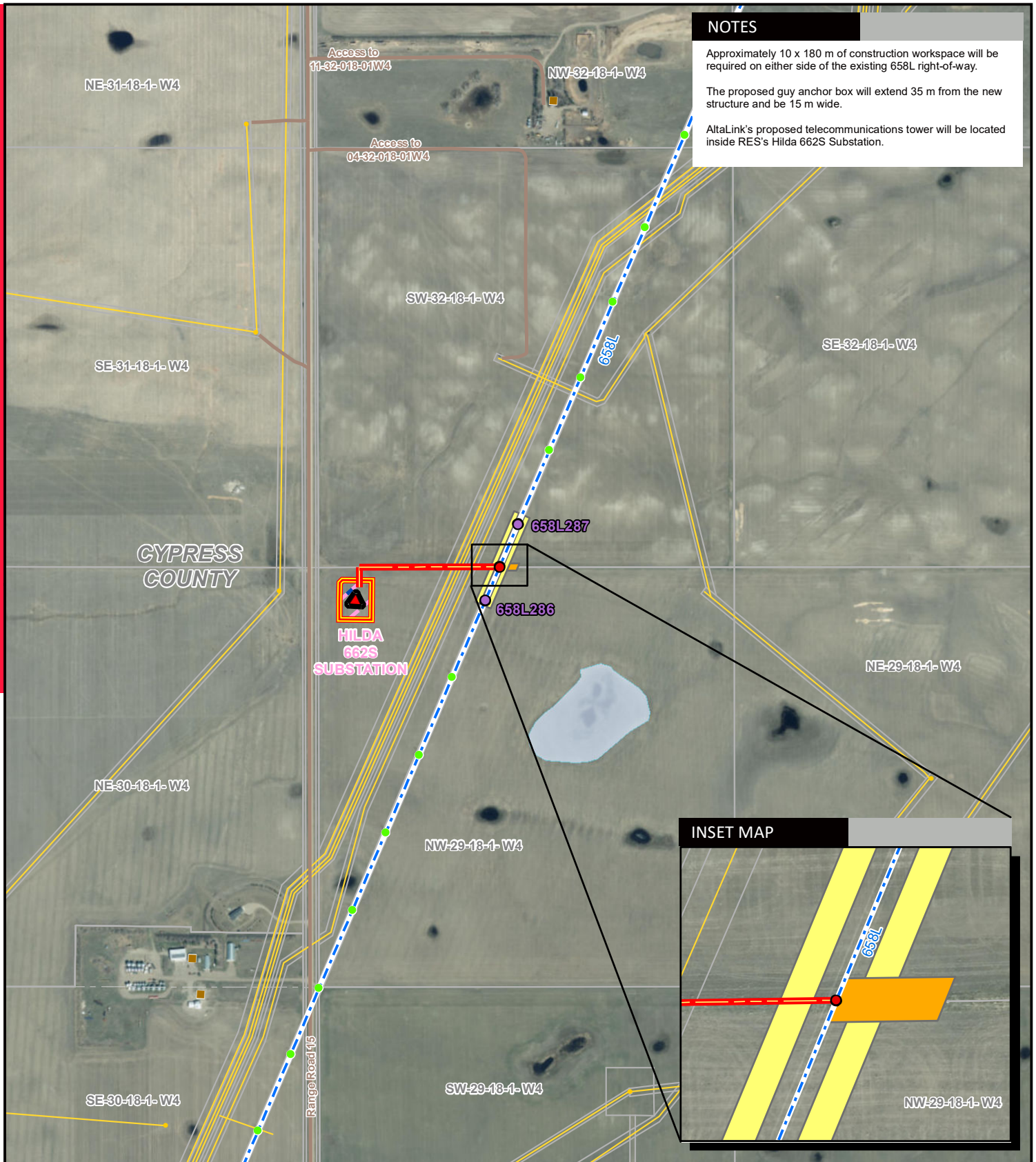





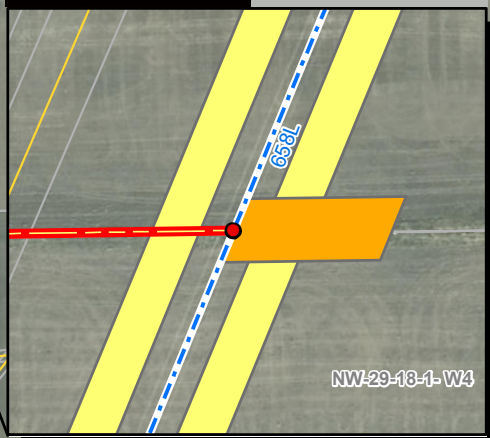







AltaLink's proposed telecommunications tower will be located inside RES's Hilda 662S Substation.



**INSET MAP**



**LEGEND**

-  Proposed Telecommunication Tower
-  Proposed New Structure
-  Proposed Modification of Existing Structure
-  Existing Structure
-  Proposed Customer Transmission Line
-  Existing Transmission Line
-  Approved Customer Substation
-  Proposed Guy Anchor
-  Construction Workspace
-  Residence
-  Wellsite
-  Pipeline
-  Road
-  Water Body

NO: 35029190 - 0025  
 DRAWN: SG - AL  
 FILE NO.: XXXXXXXX  
 REVISION: 0.03.07  
 AL FOLDER: RESC Hilda MPC  
 100MW Wind  
**DATE: 2022-01-19**

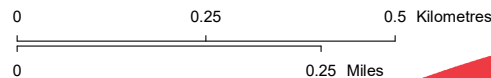

**DETAIL PHOTO DP1**



**PROPOSED**

**Hilda Wind Power Project Connection**

Service Layer Credits: Source: Esri, Maxar, GeoEye, Earthstar Geographics, CNES/Airbus DS, USDA, USGS, AeroGRID, IGN, and the GIS User Community  
 Although there is no reason to believe that there are any errors associated with the data used to generate this product or in the product itself, users of these data are advised that errors in the data may be present.